



Certificate
of Origin

Digitalisation of certificates of origin: private sector perspective

3rd WCO Origin Conference
9 November 2023, Santiago, Chile

ICC WCF CO Governing bodies

An International CO Council

- Set up to enhance and promote the unique position of chambers as issuing agents of non-preferential and preferential certificates of origin. The Council is a global forum facilitating collaboration between chambers worldwide.

Chair: Martin Van der Weide, Policy Advisor Export and Origin, The Netherlands Chamber of Commerce (Netherlands)



Appointment of new CO Council Vice Chairs



CO Chain
(First Vice Chair)

Luc Dardaud
Paris Chamber, France



Digital CO

Li Bin
CCPIT, China



Rules of Origin

Paul Wrighting
BCC, UK



Accreditation
Committee



Digital CO
working group



Rules of origin
working group

Technical committees

CO Accreditation Committee

Contains a group of CO leaders and experts to:

- a. manage the expansion of the ICO Chain;
- b. prepare recommendations;
- c. monitor compliance; and
- d. process applications received for accreditation and recommend eligible applications for approval by the ICC WCF International Certificate of Origin Council.

Technical committees

Newly created Digital CO and Rules of origin working groups

Two new working groups created with different objectives:

- to raise the level of acceptability of eCO by stakeholders including Customs Administrations, banks for documentary credit clearance, insurance companies and importers and provide information and advice to chambers of commerce, especially members of the CO Council, about eCOs and the implementation of digital issuing system.
- To raise ICC's profile in rules of origin, providing trainings on preferential rules of origin, and work on rules of origin related to non-preferential goods: what are their origin criteria for the issuance of non-preferential CO.

Digital CO working group

Making sure that Chambers of Commerce use the same kind of system for eCO, which allow the verification of the CO on a central platform

The screenshot shows the 'Accredited chambers' page on the ICC CO Verification website. The page features a dark blue header with the ICC logo and 'Certificate of Origin' text. Below the header, the title 'Accredited chambers' is displayed. A paragraph explains the website's purpose: 'This website, hosted by the ICC World Chambers Federation (WCF), aims to offer Customs Authorities and chambers the possibility to verify the authenticity of certificates of origin issued by chambers of commerce members of the International CO Accreditation Chain.' Below this, a link 'Accredited chambers' is provided. A note mentions that the connection for the Dubai Chamber of Commerce has not yet been made. The main content is a grid of 24 boxes, each containing a national flag and the name of an accredited country.

Austria	Belgium	Brazil	Bulgaria	Canada	China
Denmark	Finland	France	Iran (Islamic Republic of)	Ireland	Italy
Korea (Republic of)	Lebanon	Liechtenstein	Malta	Netherlands	New Zealand
Norway	Portugal	Qatar	Singapore	Slovakia	Slovenia
South Africa	Sweden	Switzerland	United Arab Emirates	United Kingdom	United States of America

Certificates of origin

Verification website



To verify the Certificate of Origin you hold, please scan here the QR Code on the CO Form (currently available for CO issued from 1 April 2022 from Finland).

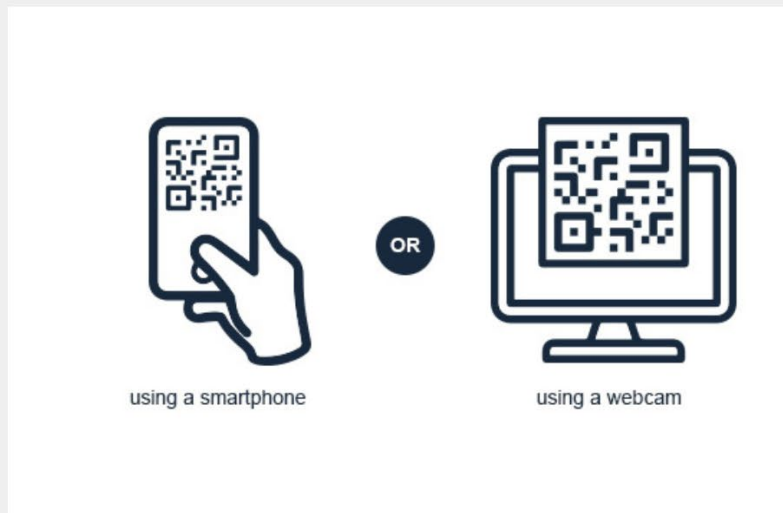

SCAN THE QR CODE

Input the key records and look up

Finland ▼

(FI1800301) Helsinki Region Chamber of Commerce ▼

FI-E1153730426

2022-05-25 📅

International Chamber of Commerce

76354d

SEARCH

Digital CO working group

How new digital developments will impact the process of COs

- Brief chambers of commerce on relevant new developments in the field.
- For example, the working group would evaluate the blockchain technology and artificial intelligence (AI) and how it could be applied as a useful tool to address challenges to trade digitalisation.

At the Netherlands Chamber of Commerce (KVK)

Some figures:

- 100% e-CO with an option for the exporter to print.
- 800,000 documents a year, this is 3,000 documents issued per day!
- Automatic approval: the system will handle these documents – 40% of all documents.

At the Netherlands Chamber of Commerce (KVK)

The stages of development

- I'm not talking about the benefit of e-CO system, I'm not going to tell you how excellent they work and how the work.
- 3 “stages” of developments we experienced.
 - 1) The first development: the start of the system;
 - 2) The roll-out phase to all exporters/applicants;
 - 3) The back-up system.

In the Netherlands, we are at phase 3

At the Netherlands Chamber of Commerce (KVK)

Phase 1: The first development: the start of the system

The start of the e-CO system:

- In the Netherlands, we started in 2009 with the first developments.
 - The phase of building the system
 - The phase of making mistakes
1. A secure printing process, not relevant because original/copy is in a digital world not the same as in a paper world.
 2. Try to copy all the elements of a paper process into a digital process.

But after phase 1, we have (like you all) an excellent e-CO system that is faster, better and more secure than a manual system.

At the Netherlands Chamber of Commerce (KVK)

Phase 2: Making improvements to the system and make sure that all exporters/applicants are going to use the system

- In the Netherlands, this was the period between 2014 and 2019.
- Step-by-step all exporters are using the system.
- All acceptance problems were solved (already before 2015).

At the Netherlands Chamber of Commerce (KVK)

Phase 3 – The back-up system

German Chambers of Industry and Commerce hit by a massive cyberattack

Updated on: 08 August 2022

Jurgita Lapienyte, Chief Editor

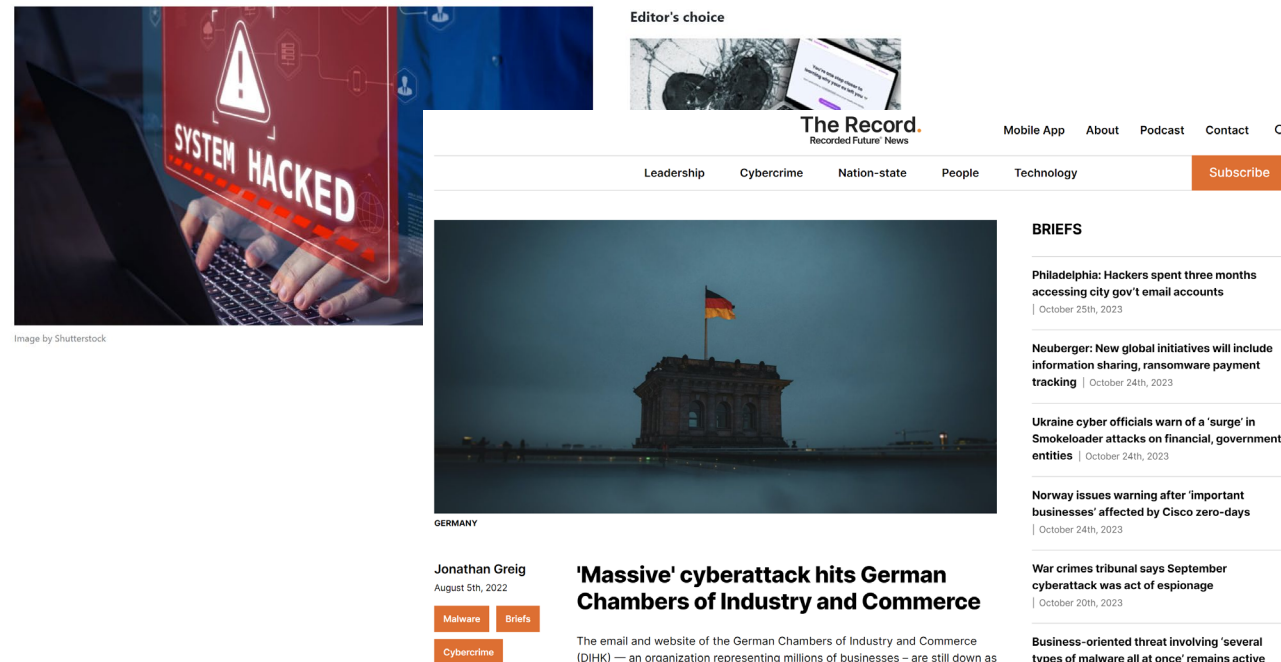

The screenshot shows a news article from 'The Record' (Recorded Future News) titled 'Massive' cyberattack hits German Chambers of Industry and Commerce'. The article is dated August 5th, 2022, and is categorized under 'Cybercrime'. The main image shows a person's hands typing on a laptop keyboard with a 'SYSTEM HACKED' warning sign overlaid. The article text states: 'The email and website of the German Chambers of Industry and Commerce (DIHK) — an organization representing millions of businesses — are still down as'. The article is also categorized under 'Malware' and 'Briefs'. The website header includes navigation links for Leadership, Cybercrime, Nation-state, People, and Technology, along with a 'Subscribe' button. A 'BRIEFS' section on the right lists other news items, including 'Philadelphia: Hackers spent three months accessing city gov't email accounts' and 'Ukraine cyber officials warn of a 'surge' in Smokeloder attacks on financial, government entities'.

German Chambers of Industry and Commerce hit by 'massive' cyberattack

By Bill Toulas

August 4, 2022 10:06 AM 0



The Association of German Chambers of Industry and Commerce (DIHK) was forced to shut down all of its IT systems and switch off digital services, telephones, and email servers, in response to a cyberattack.

DIHK is a coalition of 79 chambers representing companies within the German state, with over three million members comprising businesses ranging from small shops to large enterprises in the country.

At the Netherlands Chamber of Commerce (KVK)

Phase 3 – The back-up system

- What happened there, and what does that mean for my e-CO system?
- In phase 1 and 2, the back-up plan was always back to manual, and of course we have taken a lot of measures to secure the system. There are also measures taken in case of for example a fire.
- But if a situation like in Germany will take place and the system is down for several weeks, is a manual back-up plan still an option?

At the Netherlands Chamber of Commerce (KVK)

We believe not. What about you?

- Can you protect your system from a cyber-attack?
- How long will it take to get your system up and running again after a cyber-attack?
- If it is between 1 and 3 days, you might be lucky, If it can be weeks, you will be in “trouble”

At the Netherlands Chamber of Commerce (KVK)

Why is going back to manual not option anymore ? (Take in mind we issue non-preferential CO, there is a time pressure)

1. My exporters are not used to it anymore;
2. The staff of the Chamber is not used it anymore;
3. We have less offices in the Netherlands, the distance between the Chamber and the applicant is bigger;
4. Every new (small) digital development will take you more and more away of a manual process for example replacing the signature by a QR-code;
5. What about automatic approval, there is a workload of 40% more documents in a manual world;
6. AI – there are organization who are more and more working with AI for checks and risk-management, it in line with 4 and 5, just underlining that going back to manual might still exist in your head, but might not be an option anymore.

At the Netherlands Chamber of Commerce (KVK)

Way forward, next steps?

- We are working on it, but we do not have the solution yet.

I believe that it is not that simple as some IT developers might tell you, or maybe it is that simple.

- I only know that once you are at 100% e-CO's your manual back up process will disappear.



Thank you for your attention.

Martin van der Weide

Policy Advisor on Origin, Netherlands Chamber of
Commerce

Chair, ICC World Chambers Federation
International Certificate of Origin Council

Email: martin.vander.weide@kvk.nl

ABOUT ICC

The International Chamber of Commerce (ICC) is the institutional representative of more than 45 million companies in over 100 countries. ICC's core mission is to make business work for everyone, every day, everywhere. Through a unique mix of advocacy, solutions and standard setting, we promote international trade, responsible business conduct and a global approach to regulation, in addition to providing market-leading dispute resolution services. Our members include many of the world's leading companies, SMEs, business associations and local chambers of commerce.

www.iccwbo.org Follow us on Twitter: @iccwbo

33-43 avenue du Président Wilson,
75116 Paris, France
T +33 (0) 1 49 53 28 28 E icc@iccwbo.org

