

MAXTRON EPR EPRS SERIES

Rack / Tower Convertible

6kVA - 10kVA



Adjustable LCD/LED panel

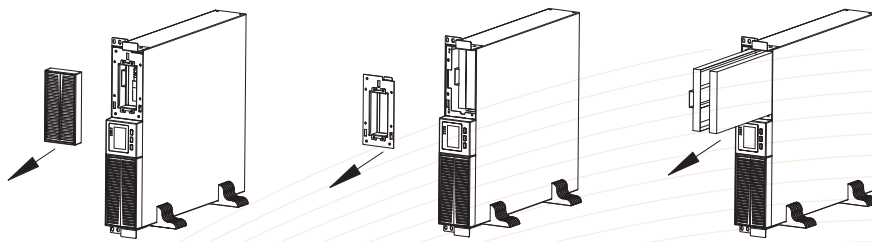

Easy for maintenance, hot-swappable battery



TRUE ONLINE RT UPS
- Single Phase

Features

- Advanced DSP and 3-level technology
- Output power factor 1.0
- High form factor flexibility, with the option of mounting as a rackmount in a server rack or as a tower depending on the environment space
- Active power factor correction (APFC), Input power factor up to 0.99
- High efficiency 95% (up to 98% in ECO mode)
- Advanced digital parallel technology
- Wide input voltage range (110 ~ 288 Vac) and frequency range (40 ~ 70 Hz)
- 50/60 Hz frequency auto sensing
- Two modes of frequency conversion: 50Hz input / 60Hz output or 60Hz input / 50Hz output
- Hot-swappable battery
- Flexible battery configuration (settable 16-20 pcs batteries)
- Digitally controlled charger
- High charging current available (Max. 12A)
- Charging voltage and current configured by demands
- Linear derating in low voltage input reducing battery discharging times, extending the service life of battery
- Intelligent battery management, automatic floating / equalizing charge control, charger dormancy control, increasing battery life by 50%
- Settable delayed start time when mains power is restored, reducing the impact on power grid or generator
- Fans speed varies intelligently with temperatures, reducing noise and extending its service life
- Equipped with self-aging function
- Compact internal layout, miniaturized the complete unit for small footprint
- LCD+LED display, multi-functional keys operation, friendly human-machine interface
- Powerful background software for parameter configuration
- Ideal hardware protection and software integration support with Windows and Linux such as some Hyperconverged Infrastructures (HCI) servers, storage systems and other IT equipment

Available Options

- RS232 and smart card slot included
- Optional parallel function, battery temperature compensation, SNMP card, USB, RS485 card, dry contacts, EMD and SMS alarms



TRUE ONLINE UPS

MAXTRON EPR EPRS SERIES

Rear Panel

- | | |
|------------------------------|-------------------------------------|
| 1. Intelligent Slot | 7. Temperature Detection (optional) |
| 2. Fans | 8. GND |
| 3. Parallel Port (optional) | 9. Bypass Breaker |
| 4. RS232 | 10. Terminal and Cover |
| 5. Emergency Power Off (EPO) | 11. Battery Pack |
| 6. USB (optional) | |



6000VA / 10000VA (S)

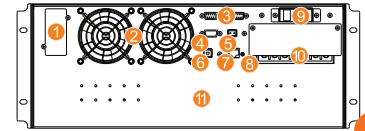

6000VA / 10000VA

MODEL	MX-6000EPR / MX-6000EPRS	MX-10000EPR / MX-10000EPRS
Capacity	6000VA / 6000W	10000VA / 10000W
INPUT		
Input Wiring	Single Phase Three Wire (1Φ + N + PE)	
Rated Voltage	208 / 220 / 230 / 240VAC	
Voltage Range	110-176VAC (Linear derating between 50 % and 100 % load) ; 176-288VAC (No derating)	
Rated Frequency	50 / 60 Hz (Auto Sensing)	
Frequency Range	40 Hz ~ 70 Hz	
Power Factor	1.0	
Bypass Voltage Range	-40 % ~ + 15 % (Settable)	
Total Harmonic Distortion (THDi)	≤ 5 %	
OUTPUT		
Output Wiring	Single Phase (L - N)	
Rated Voltage	208 (PF = 0.9) / 220 / 230 / 240VAC	
Voltage Regulation	± 1 %	
Frequency	Synchronized to bypass in mains mode; 50/60 Hz ± 0.1 % Hz in battery mode	
Power Factor	0.8	
Total Harmonic Distortion (THDi)	≤ 1 % (Linear load) ; ≤ 4 % (Non-linear load)	
Crest Factor	3:01	
Overload	102 % ~ 110 % for 10 min , 110 % ~ 125 % for 1 min . 125 % ~ 150 % for 30s	
TOPOLOGY		
Transfer Time	0 ms	
Waveform	Sinusoidal	
SYSTEM		
LCD Display	Input / Output Voltage, Load Level, Battery Level, UPS Status and Fault Conditions	
Communications	RS232 (standard) , USB / RS485 / Dry Contacts / SNMP / Battery Temperature Compensation (Optional)	
SAFETY		
Full Protection	Short-circuit, Overload, Overtemperature, Battery Low Voltage, Overvoltage, Undervoltage and Fan Failure	
BATTERIES		
DC Voltage	192VDC (192 - 240VDC Settable)	
Number of Battery	16 pcs (16-20 Settable)	
Inbuilt Battery (Standard Model)	12V 7AH / 12V 9AH x 16	
Autonomy	Min 30minutes or Depending on the equipment loads	
Charging Current	Standard model: 1A; Long time model: 5A (default), 1 - 5 A settable; 12A (optional)	
Recharge Time	Standard model: 90 % restored in 8 hours; Long time model: depend on the capacity of battery	
Efficiency	≥ 94 % at 100 % load , max . 94.5 % at 60 % load , ≥ 98 % in ECO mode	
Maximum Number of Parallel Connections	4	
STANDARDS / APPROVALS		
Compliances	SIRIM, CE	
IP Rating	IP 20	
ENVIRONMENT		
Operating Temperature	0°C ~ 40°C	
Storage Temperature	-25°C ~ 55 °C (without battery)	
Relative Humidity	0% ~ 95 % (non -condensing)	
Altitude	≤ 1000m, derating 1% for each additional 100m	
Noise Level at 1 m	≤ 55 dB	≤ 58 dB
PHYSICAL PROPERTIES		
Dimensions (W x D x H) mm	440 x 580 x 88 (2U), EBM ¹ : W440 x D580 x H132mm (3U)	
Net weight (kg)	12 (S) ²	14 (S)
Gross weight (kg)	14 (S)	16 (S)
WARRANTY & SUPPORT		
Product Warranty	3 Years Warranty for UPS Parts and Labour. 2 Years for VRLA Rechargeble Batteries.	

1. EBM =External Battery Module
2. S means long run model.

• Specification contained in this document, and to prices are reserved; so are errors and omissions.
Only order confirmations and technical documentation by KOSS UPS is binding.

• Ver1. March 2024

© POWER LOGIC (M) SDN BHD. All right reserved.

TRUE ONLINE RT UPS
- Single Phase



POWER LOGIC

No. 2-10, Jalan Kenari 12B, Bandar Puchong Jaya, 47100 Puchong, Selangor Darul Ehsan. Tel: (603) 8070 5899

E-mail: enquiry@kossups.com.my